

APPELLANT EXHIBIT 4

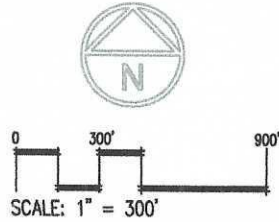
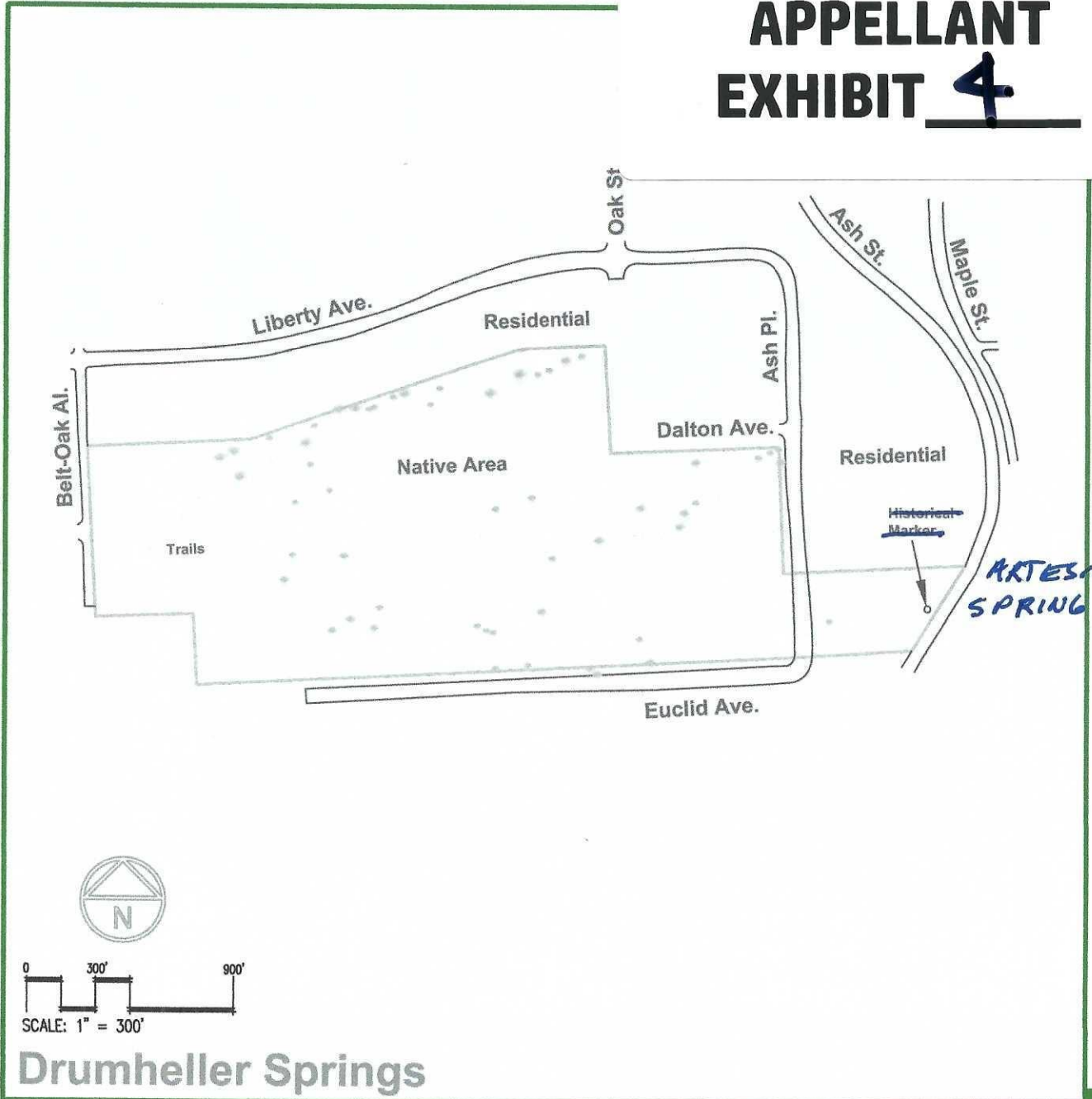

Drumheller Springs

SHELTER:.....
 ELECTRICITY:.....
 PLAY EQUIPMENT:.....
 RESTROOM:.....
 SOFTBALL / BASEBALL:.....
 ADA ACCESS:.....
 PICNIC AREA:.....
 AUTOMATIC IRRIGATION:.....
 SPLASH PAD:.....
 ON SITE PARKING SPACES:.....
 SPORT FACILITIES:.....
 COMMENTS:

TOTAL PARK (ACRES):.....	12.01
UNDEVELOPED:.....	12.01
SCHOOL OWNED:.....	
TOTAL DEVELOPED:.....	



DRUMHELLER SPRINGS
CONSERVATION LAND
 MAP INDEX #: **90**
 LOCATION: EUCLID AND ASH

GALLERY

Bigelow Gulch problems

The county's effort to remake Bigelow Gulch has hit some speed bumps. For one thing, it's expecting a significant cost overrun for its next phase of the project and is asking SRTC to make up the difference. For another, water from a natural spring is leaking through the asphalt near the Bigelow Gulch-Forker Rd. interchange, leading to ice on the road and dangerous conditions. The county has big signs up asking people to be cautious.

Fri., Feb. 12, 2021



Vehicles approaching from the west on Bigelow Gultch Road are warned of water from a natural spring leaking through the asphalt near the Bigelow Gulch-Forker Rd. interchange, Wednesday, Feb. 10, 2021, leading to ice on the road and dangerous conditions.

Dan Pelle Thesokesman-Review [Buy this photo](#)